

How to get to the SP8 of the ZMB @ Balgrist Campus

How to get to the SP8 of the Center for Microscopy and Image Analysis @ Balgrist Campus
Lengghalde 5 CH-8008 Zürich

Written By: Urs Ziegler



INTRODUCTION

How to get to the SP8 of the

Center for Microscopy and Image Analysis @ Balgrist Campus

Lengghalde 5

CH-8008 Zürich

Step 1 — Go to Balgrist Campus

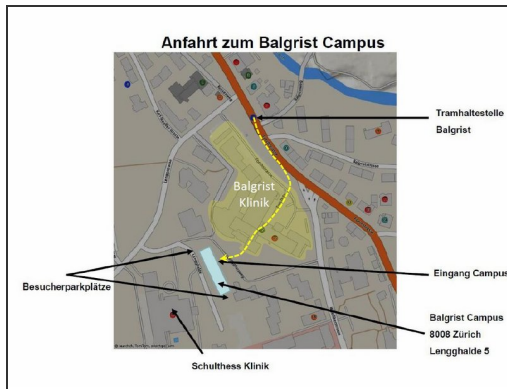

- Go to Balgrist Campus, Lengghalde 5 , CH-8008 Zürich
- Please note: The Balgrist Campus is the glass building behind the main hospital building.

Step 2 — Enter the Building - Reception Desk

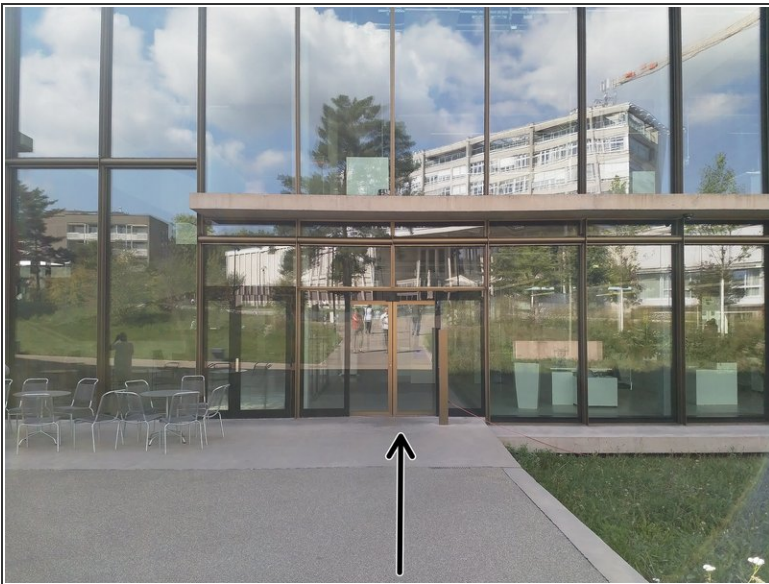

- ⚠ With access card for the Balgrist Campus: the campus and microscope can be accessed 24/7.
- ⚠ Without access card: please arrange a guest card at the reception desk (8:00-17:00 on weekdays). Mention Sander Botter or Knut Husmann as your contact.

- Enter the building through the main entrance.
- Reception desk

Step 3 — Proceed to microscope

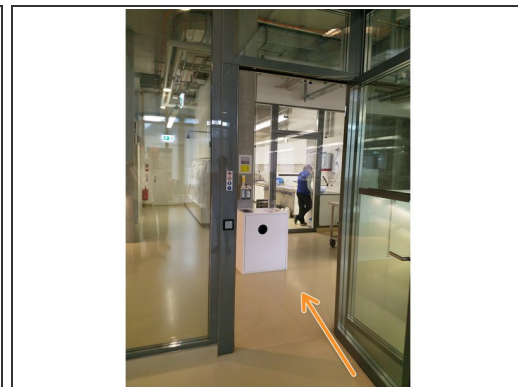
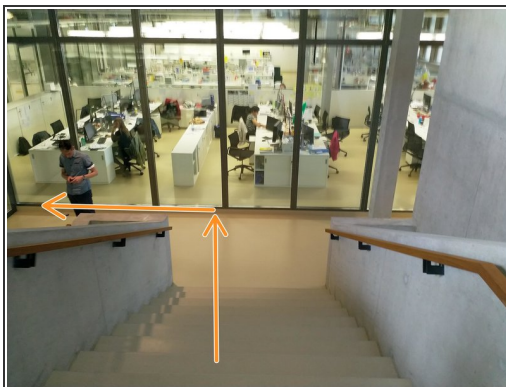
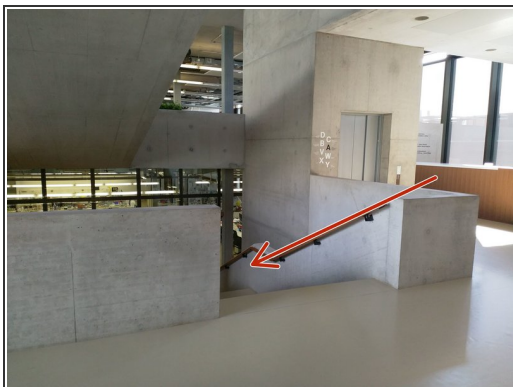

- Use the stairs opposite the reception desk to go half a floor down.
- Go through the glass door "Wet Lab V.552" to the left.

Step 4 — Proceed to the microscope

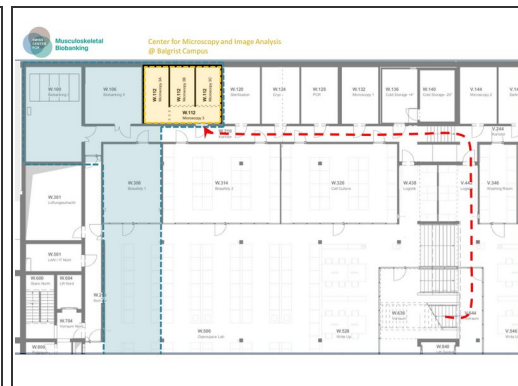
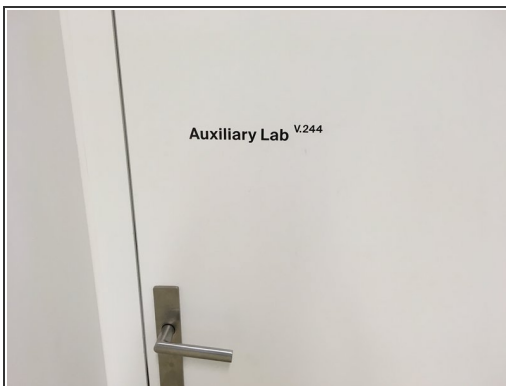
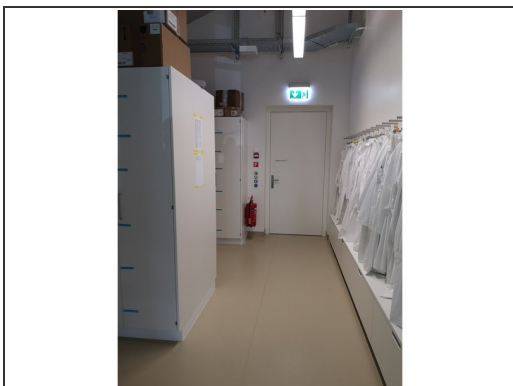

- Proceed straight ahead and enter the door "Auxiliary Lab V.244". Turn left and use the stairs to go half a floor down.
- Proceed along the corridor.

Step 5 — Arriving at the microscope room



- Proceed along the corridor to the room 'Microscopy 3 W.112'
- Use your access batch from the Balgrist Campus to open the door. The light switch (manual on - automatic off) for the hallway area inside W.112 is located directly at the right hand side
- ❗ You made it! The Leica SP 8 The microscope is directly straight ahead !
- ⚠ Do not enter the other microscope cubicles - experiments may be going on! Do not remove anything from the other microscopes!

Step 6 — Light control in room

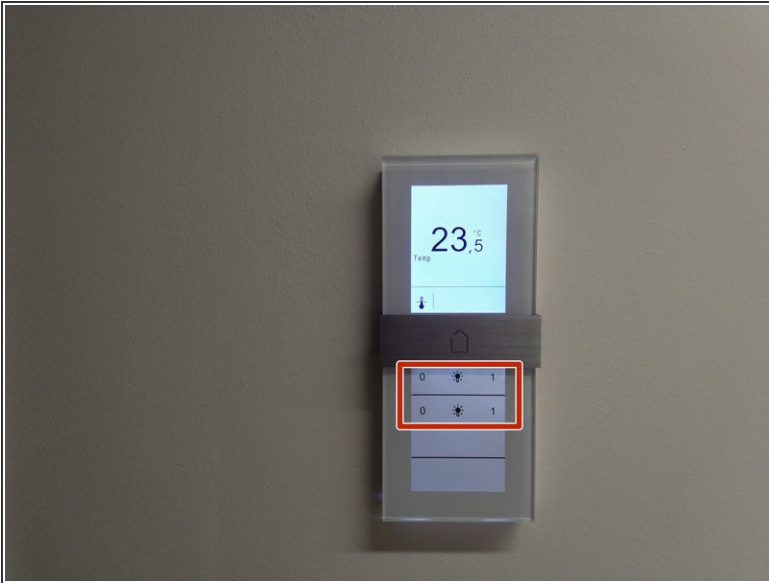

- Main ceiling light (cubicle only; hallway area only; manual on - automatic off)
- Light control to dim the desk light (bright - dark / warm - cool light color)